



→ Fold-away lift for trucks, trailers & semi-trailers

DH-RM(C).20 • 1000 - 2000 kg



The DH-RM.20 is equipped with a robust lift frame, a wide arm center and 2 lift cylinders. Hence it serves the **heavy-duty end of the fold-away lift market**. It is equipped with a wedged platform, offering a level ride from the vehicle floor to the ground (and vice versa), including **automatic tilt at ground level**.

In its travel position, the DH-RM.20 is safely stored underneath the chassis of the vehicle. It is ideal for operations needing frequent fork lift loading or access to loading docks, and all applications requiring quick and free access to the cargo space. The relatively short platforms of fold-away lifts are more recommended for roll cages, white and brown goods, parcels, etc... than for pallet work.

There are 2 executions: the DH-RM.20 with fixed stabilisers, and the DH-RMC.20 with tilt cylinders and **adjustable platform orientation**.

The special model DH-RMV.20 is specially designed for trucks with a **draw-bar coupling** (for central-axle trailers).

Lift capacity

CAP	CG	LM
1000 kg	600 mm	6 kNm
1500 kg	600 mm	9 kNm
2000 kg	600 mm	12 kNm

Weights [see pg. 15]

ALU / ALU		STEEL / ALU	
1150 mm	410 kg	1150 mm	433 kg
1250mm	415 kg	1250mm	440 kg
1450 mm	425 kg	1450 mm	455 kg

Weights incl. CE bumper

Heavy duty fold-away lift with 2 lift cylinders

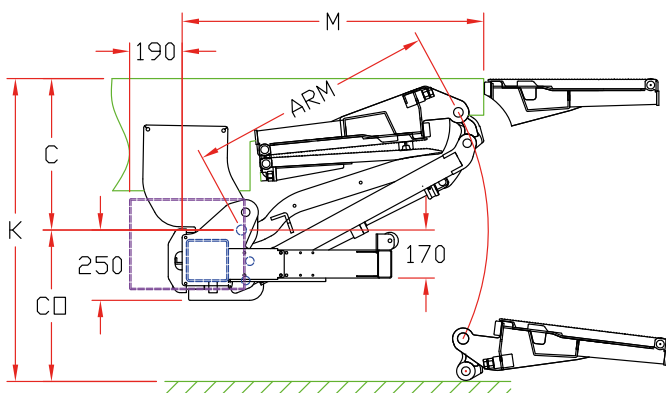

Fitting dimensions

ARM		880	1000	1050 (*)
K max.		1390	1560	1660
K min. loaded		1000	1110	1210
C max.		720	815	910
C min.		500	500	400
CO max.		670	745	750
M	at C max.	940	1050	970
M	at C min.	1125	1260	1300
V max		1250	1450	1600 (*)

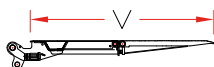

(*) For 2000 kg - 1600 mm, it is strongly recommended to use the model DH-RM.25

Technical specifications

Lift frame	150 x 150 mm
Cylinders	2 lift cylinders + 2 tilt cylinders (DH-RMC) or 2 fixed stabilisers (DH-RM)
Type of ride [see pg. 8-9]	Wedged platform, level ride with automatic tilt at ground level
Platform material	Steel / Alu • Alu / Alu
Standard platform depths	1150 - 1250 - 1450 - 1600 mm 1600 mm on special request (*)
Standard platform widths	2000 - 2200 mm 2350 mm on request (option OAP603)
Lift arm lengths	880 - 1000 - 1050 (*) mm
Lift arm widths	1150 - 1400 mm
Mounting	<ul style="list-style-type: none"> • With floor plate (option OAM003) • Adapted for refrigerated floor (option S409)
Standard control unit [see pg. 11]	OAE030.BT
Standard finish of the lift frame	Protection PLUS [OAT102]