



→ Cantilever lift for trucks, trailers and semi-trailers

DH-LKG.05 • 500 kg



The **DH-LKG.05** is a robust cantilever lift, designed for the **distribution of gas bottles**. It is equipped with a flat platform to give maximum stability to the gas bottles while lifting / lowering and is available with various types of safety rails, that allow to secure the bottles in vertical position.

In order to keep the operation as simple as possible, the platform is opened / closed by hand, supported by powerful torsion springs. The reinforced steel platform offers 925x1100 mm useful loading space and allows to handle multiple bottles during any lift / lowering cycle, up to max. 500 kg safe working load.

Lift capacity

CAP	CG	LM
500 kg	500 mm	2.5 kNm

Weights [see pg. 15]

STEEL platform	
925x1100 mm	220 kg

Flat platform, specially designed for gas bottles

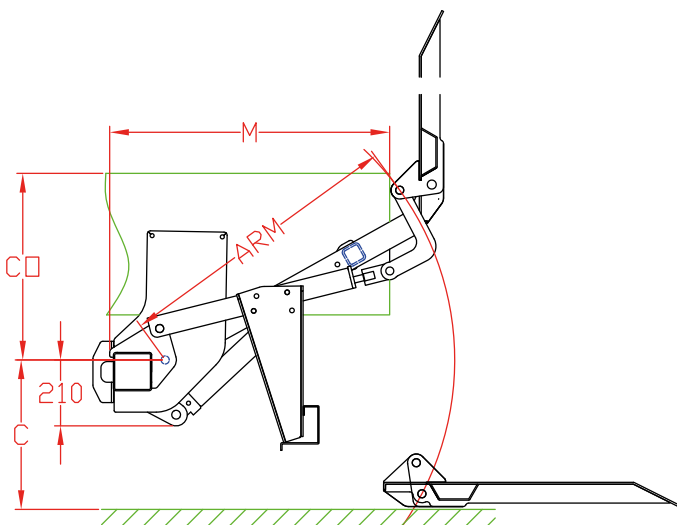

Fitting dimensions

ARM		1000
K max.		1490
C max.		730
C min.		400
CO max.		760
M	at C max.	760
M	at C min.	975

OAP206.L / .R



OAP207



Technical specifications

Lift frame	120 x 120 mm
Cylinders	1 central lift cylinder + 2 fixed stabilisers
Type of ride [see pg. 8-9]	Flat platform, level ride
Platform material	Steel
Standard platform dimensions	925 x 1100 mm (L x W) Other dimensions on request
Lift arm lengths	1000 mm
Lift arm width	350 mm
Standard control unit [see pg. 10]	OAE015 Fixed 2-button exterior control box
Standard finish of the lift frame	Hot-dip zinc plated finish [OAT104]